

SEZIONE B-B'

E GUGLIELMO OBERDAN

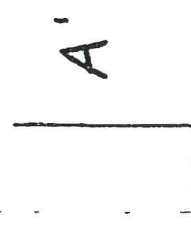

CIGLIO MARCIAPIEDE

SOSTA AUTOCARRO
(7,50 X 2,00)

2,00

SPAZIO VENDITA
(7,50 X 1,50)

B

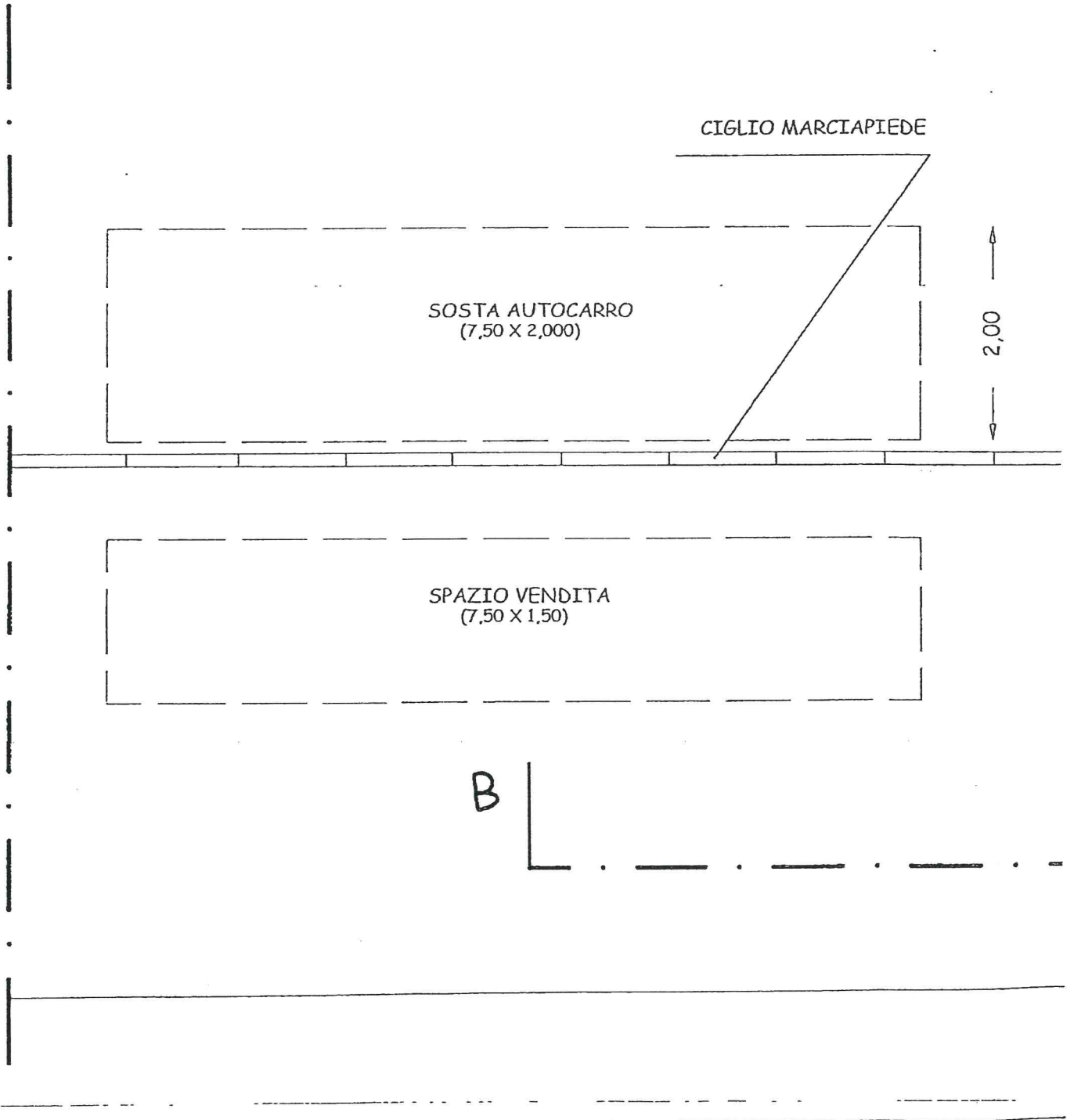

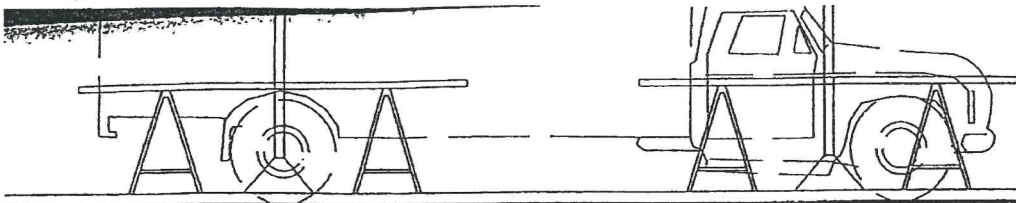

SEZIONE B-B'

GUGLIELMO OBERDAN

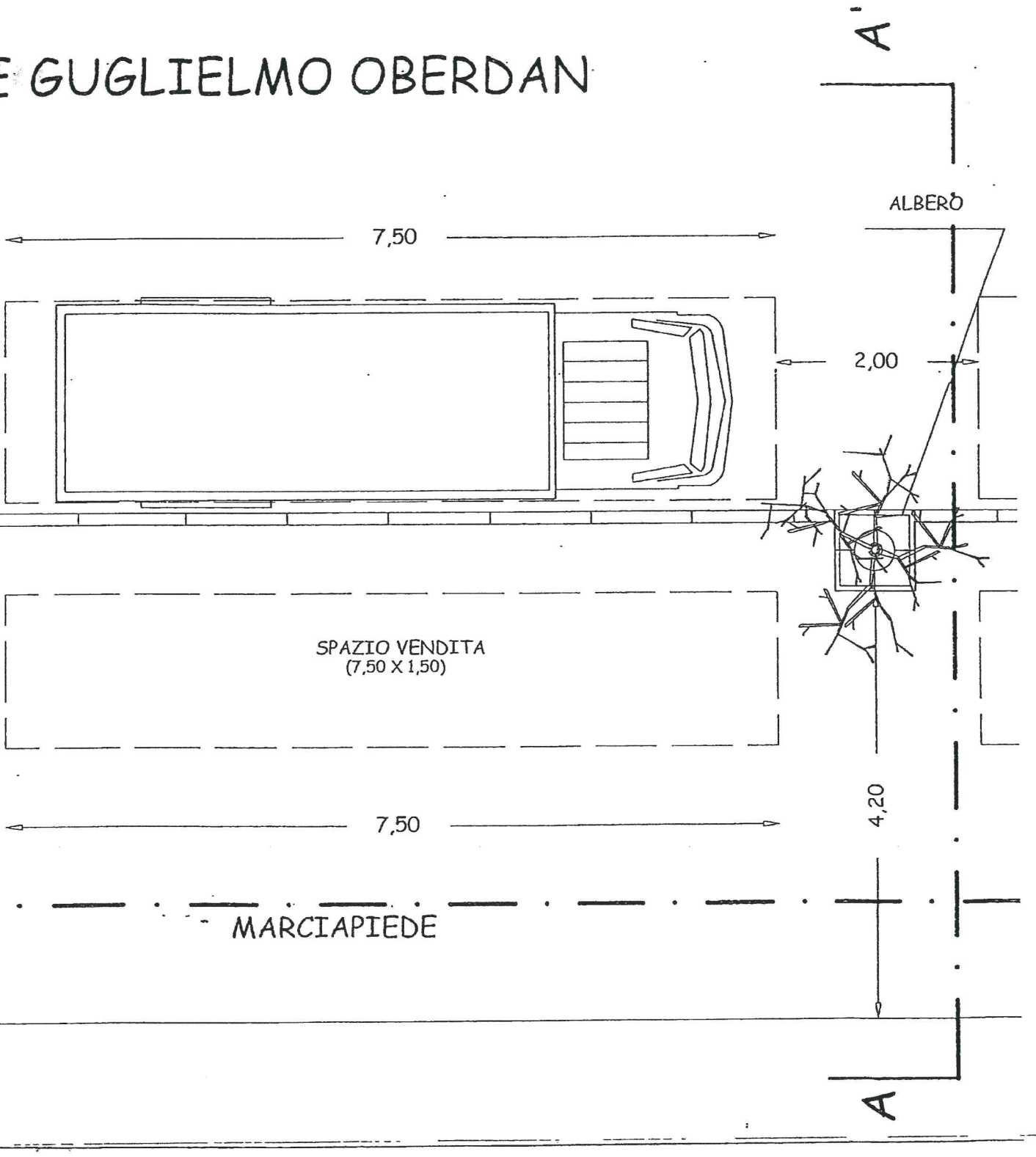

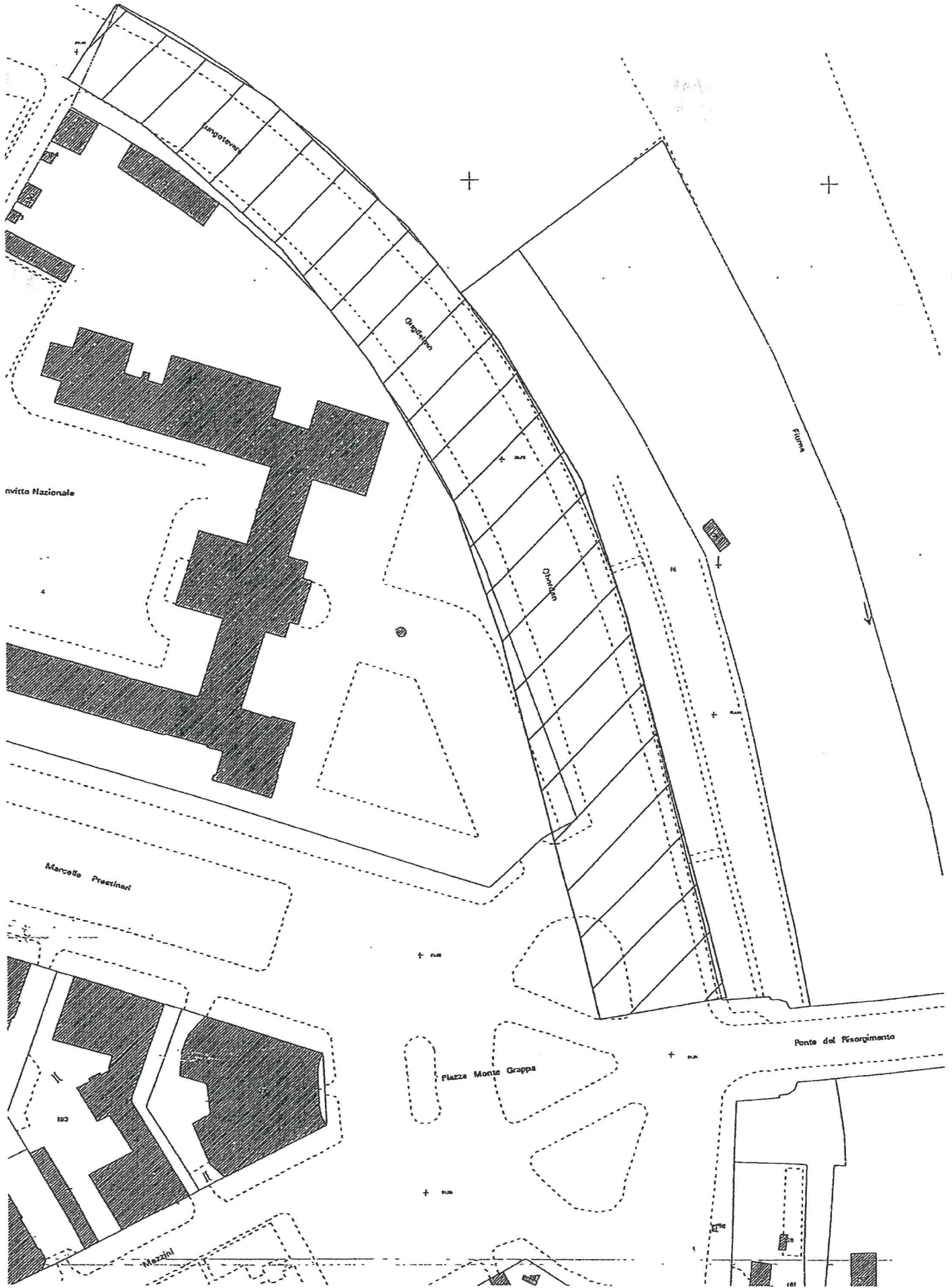

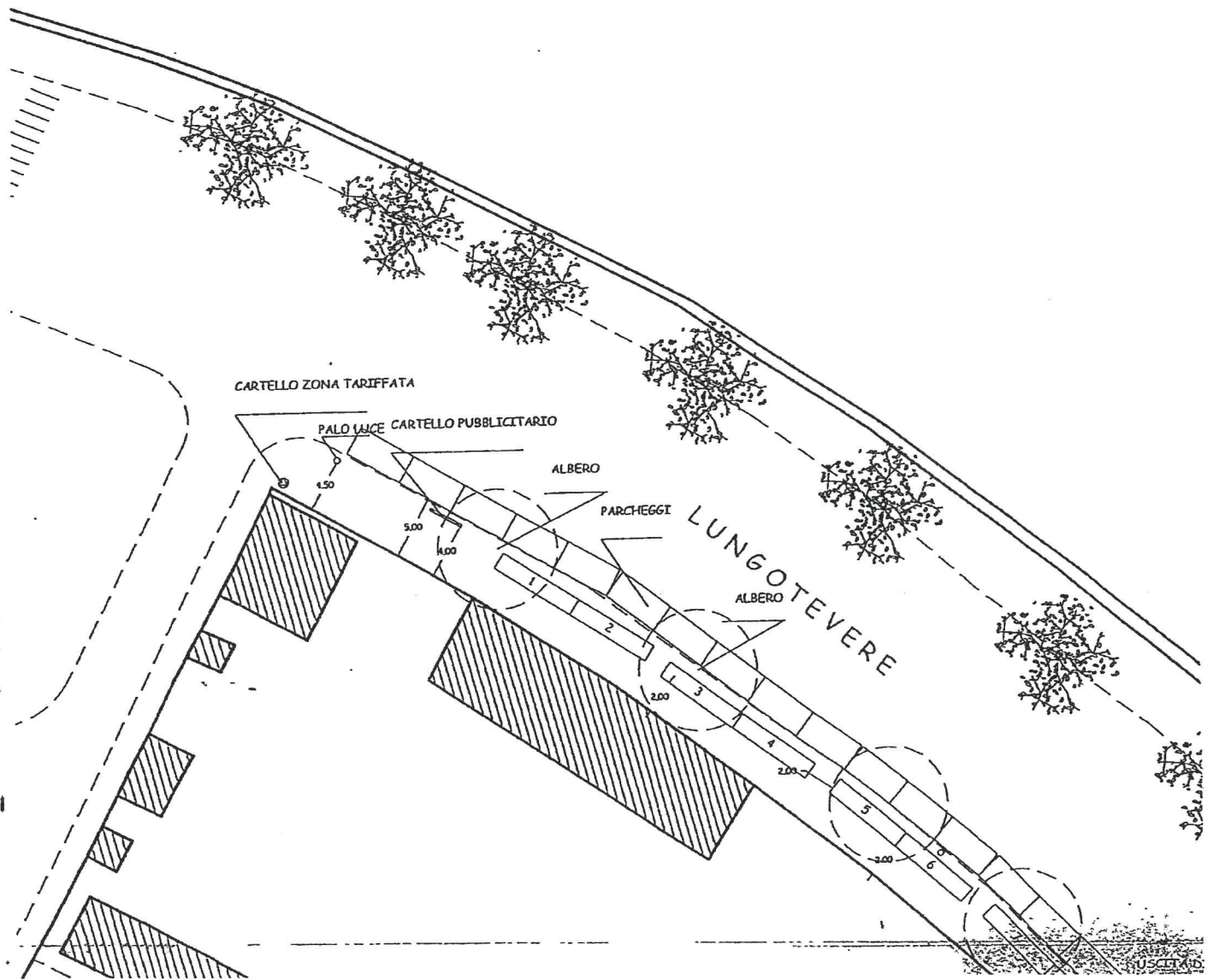

MUSCATA

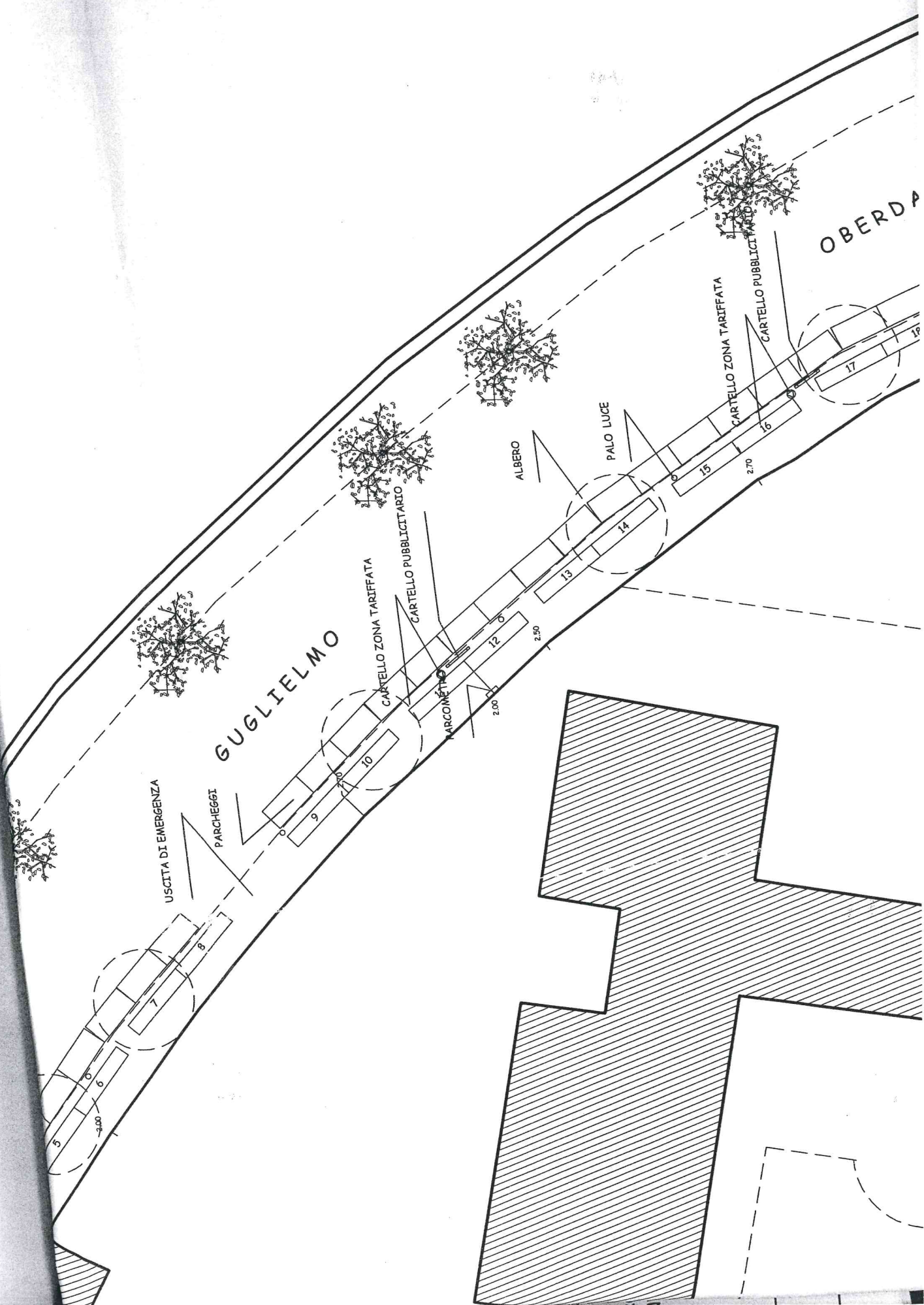

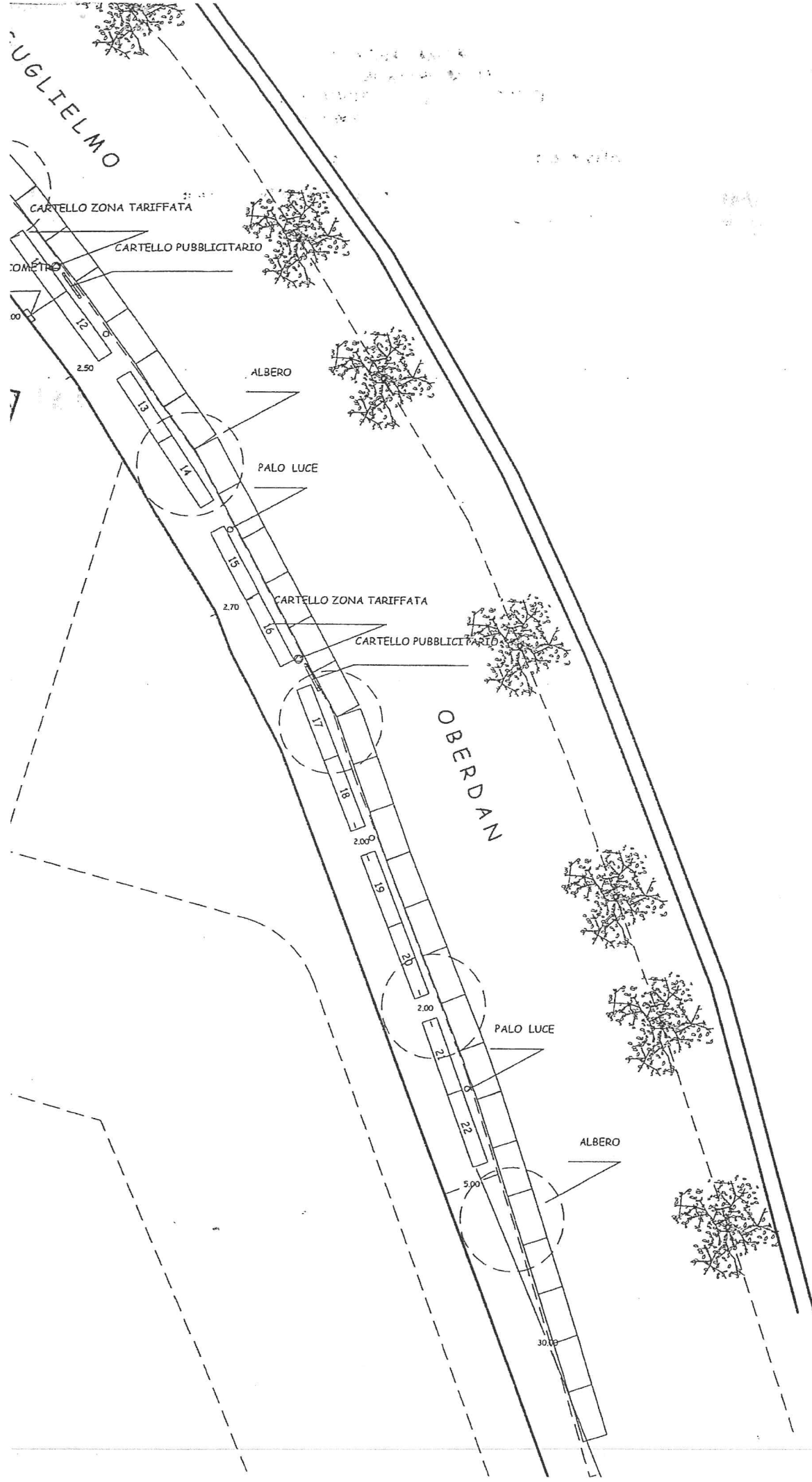

UGLIELMO

CARTELLO ZONA TARIFFATA

CARTELLO PUBBLICITARIO

COMETRO

ALBERO

PALO LUCE

CARTELLO ZONA TARIFFATA

CARTELLO PUBBLICITARIO

OBERDAN

PALO LUCE

ALBERO

30.00